

*Designed for:* **Restaurants  
Fast Food Locations  
Shopping Plazas  
Supermarkets  
Hospitals  
Schools  
Nursing Homes  
Hotels**

**Pak-Tite: 4 to 1\***  
Compaction Ratio

**Front, Side or Rear  
Load Feed Design**

**Self-Contained,  
Liquid-Tight  
Can Design**

**Container Guides**

**Completely 100%  
UL Approved**

**3-Way  
Safe & Secure  
Interlock System**

**Versatile Design  
will Accommodate  
a 4, 6, or 8 cu. yd.  
Container**

**Container Stops  
Eliminate Can Movement**

# VCP



**Totally  
Listed**

# VERTICAL COMPACTOR

## Self-Contained Wet/Dry Vertical Compactor (VCP)

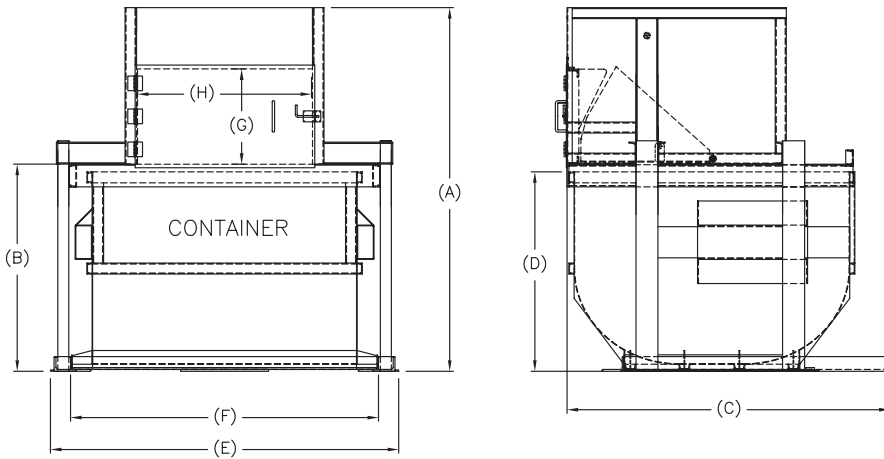

		A	B	C	D	E	F	G	H
FRONT & REAR FEED	4 YD	86"	43"	88"	41"	95"	84"	26"	47½"
	6 YD	100"	57"	88"	54½"	95"	84"	26"	47½"
	8 YD	118"	75"	88"	72½"	95"	84"	26"	47½"
SIDE FEED	4 YD	86"	43"	99"	41"	95"	84"	26"	47½"
	6 YD	100"	57"	99"	54½"	95"	84"	26"	47½"
	8 YD	118"	75"	99"	72½"	95"	84"	26"	47½"
REAR LOAD	4 YD	92"	52"	91"	52"	96"	84"	26"	47½"

### EQUIPMENT SPECIFICATIONS

Mrf Rating	.73 cu yds	Normal Force	28,920
WASTEC Rating	.56 cu yds	Max Force	33,786
Feed Opening	26" x 47"	Electrical Motor	3 HP, 3 Phase, 208/230/460V
Cycle Time	30 secs	Electrical Control Voltage	120 VAC

The Vertical Compactor Series has been engineered to provide many years of reliable service. The heavy-duty structural steel components are welded by certified technicians and tested to ensure liquid retention and high compaction forces.

The Vertical ComPactor or "VCP," an affordable, self-contained compaction system for situations where space is limited, roll-off collection is unavailable or load versatility is desired.

### BENEFITS:

- Completely 100% UL Approved
- Feed Door Automatically locks
- "3-Way Safety First" Safety/Security Interlock
- Oversized Feed baffle eliminates trash on the platen

### OPERATIONAL MODE DESCRIPTION:

1. Insert key: Operator inserts the key then turns it to the "ON" position.
2. Engage the start button: this allows the platen to ascend from the locked mid-point position - to the up and ready-for-loading position. The feed door can now be opened and the unit is ready for loading.
3. Closing the door automatically cycles the machine and returns the platen to the mid-point position, maintaining pressure on the material while decreasing material Spring Back.

### OPTIONS:

- Oil Heater
- Chute Feed Installation
- Odor Deodorizer System

Distributed by:



**ISSA**  
The Experts  
on Cleaning and Maintenance

**WASTEC**  
MEMBER

